

Strategic.

Grandview Corporate Center
 1156 • 1160 • 1166 Dublin Road
 Grandview, Ohio

LOCATED ON THE DUBLIN ROAD CORRIDOR, JUST MINUTES

from Downtown, Port Columbus International Airport, and major interstates I-70, I-670, and I-270, Grandview Corporate Center offers a strategic location for tenants seeking prime visibility and accessibility. Ideal for corporate headquarters, office suites or showrooms, the 10-acre campus features abundant parking and a park-like setting that both employees and customers will appreciate.

Discover **Grandview Corporate Center**, and discover the potential of a strategic location.

Property Details

SIZE:

Over 70,000 square feet total in three buildings:

- 1156 Dublin Road
- 1160 Dublin Road
- 1166 Dublin Road

PARKING:

Over four cars per thousand square feet

OTHER:

- Attractive brick and glass exteriors
- Professional landscaping and manicured lawns
- Excellent visibility and signage potential
- Fully sprinklered
- Up to 14 feet clear ceiling height
- 98% net to gross space efficiency



THE WITTMANN COMPANY IS CENTRAL OHIO'S ESTABLISHED LEADER

at discovering and transforming quality real estate properties in prime locations throughout the region. With an extensive portfolio of properties in architecturally interesting buildings, we bring more than three decades of experience and expertise and a keen market understanding to every redevelopment project.

And the results speak for themselves.

From vibrant downtown spots to inspired suburban office and office/warehouse spaces, Wittmann properties offer more than in-demand amenities, features, and value. We offer the unique, distinctive appeal that today's top businesses demand.



▪ **Grandview Corporate Center** 1156 • 1160 • 1166 Dublin Road Grandview, Ohio

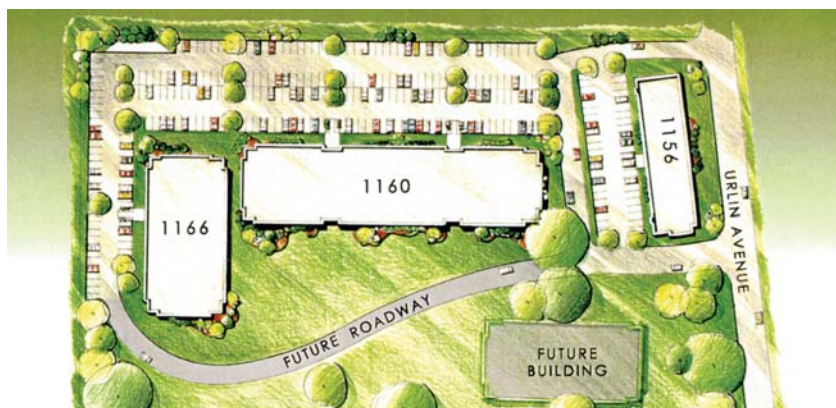

WITTMANN

FOR LEASING INFORMATION, CALL
The Wittmann Company *Potential. Rediscovered.*

330 West Spring Street
Suite 500
Columbus, Ohio 43215

614 221.0440
fax 221.0471
www.wittmann.com